

# DECEPTIVELY COOL



The Mirage by Oakford Homes is a design that lives up to its name

**TRUDY ORAM**

When I first looked at this Oakford Homes design, I admired its majestic-looking facade and thought: "Wow, here's a real grown-up home."

The Mirage is from Oakford's Marshall Thompson Collection, a range it acquired back in 2013, and it's a large two-storey design that is quite deceptive in appearance.

You'd think a home with up to four bedrooms (or three, plus a study) three living spaces, a large kitchen, double garage and a palatial ensuite bathroom would take up a lot of space, yet The Mirage lives up to its name, measuring a mere 11.62m wide.

"The design works well on a narrow block without compromising on space," Oakford Homes Kyle Heinrich says.

"The large open-plan living zone, separate lounge and further activity room (upstairs)

ensure there is no shortage of space for family and guests." A combination of stone cladding, render and a timber-look double garage door sets a modern classic tone, and to me the upper level balcony – with both a secluded and an open section with balustrade and columns – gives it a tropical/coastal feel.

That private balcony is part of the master suite with double french doors from the bedroom, where the bed can be positioned on the partition wall, which hides the walk-through wardrobe.

The room is open to the huge ensuite where a freestanding bath takes centre stage, and looks out to the private part of the balcony.

"The master suite is incredible, with walk-in wardrobe hidden behind a private screen, a spacious, luxury ensuite, and a private balcony," Kyle says. A study next to the master

suite means the homeowners can keep it as a private room and an extension of their wing, while the larger activity area on the upper landing acts as a breakout relaxation zone for the other bedrooms (both with built-in wardrobes as standard).

There's also a main bathroom on the upper level, so this gives the home two showers and two toilets upstairs, and a separate powder room downstairs.

The lower level is the home's main living hub, with a separate lounge at the front for formal entertaining or relaxing in front of the TV, and a larger kitchen/meals and family zone at the rear.

There's an undercover alfresco area as standard.

The kitchen takes up one corner of the open-plan space, with a bulkhead defining the zone. It's set in an L-shape design with a large island benchtop featuring a double sink, dishwasher provision and a breakfast bar overhang on one side. Above and below-counter cupboards offer ample

WORKS WELL ON A NARROW BLOCK

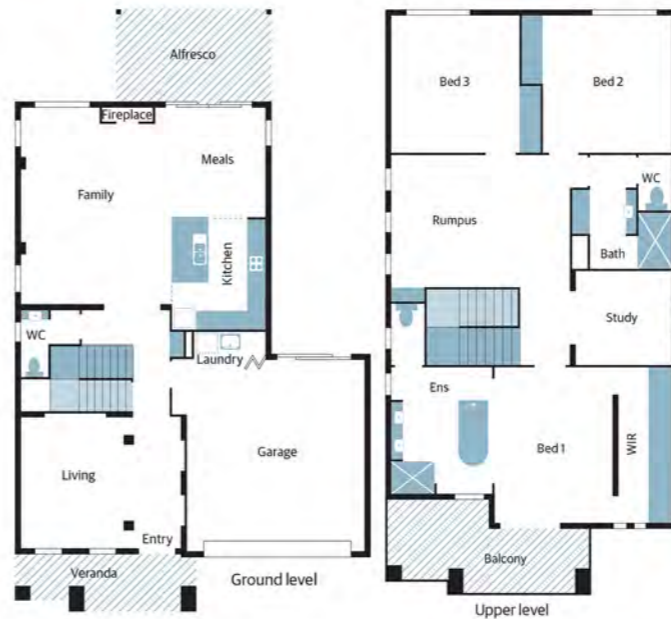

storage, making this a well-equipped design for the family cook. The meals area has sliding doors opening straight to the alfresco terrace, so there will never be an interrupted flow when entertaining with friends or family. The rest of the space is for

family living and here the look is streamlined, with symmetrical high, narrow windows framing the bulkhead niche for the television. At first glance the only thing that seems missing is the laundry, but with a second look you will see it's a

European design that is integrated into the extra-length double garage, which has sliding doors to access the washing line in the back garden. Pull back the bi-fold doors when the laundry is required, then close them back up again when not in use.



**FEATURES YOU WILL LOVE**

- Central fire:** The Mirage design includes a feature central fireplace in the open-plan family/meals area, keeping the space warm through the cooler months.
- Luxury:** How could you not want this ensuite? The bath is a focal point, while there's a wide shower is in one corner and the toilet is hidden from sight of the open bedroom.
- Set the tone:** The striking facade with a balcony – with a wide portico underneath – and finished with commercial-style box gutters give the home a polished look.

**HOME VIEW**

- 2** (Bedrooms)
- 3** (Bathrooms)
- 2.5** (Living areas)

**OFF THE PLAN**  
**Builder** Oakford Homes  
**Design** The Mirage  
**Price** From \$290,000  
**Location** Not on display, find similar, the St George Alfresco at Springwood Estate, Campbell Circuit, Gawler East

**Contact**  
 oakfordhomes.com.au  
**Details** 303.71sqm total size | 102.63sqm lower | 120.94sqm upper | 11.62m width | 19.88m depth | 3 bedrooms plus study | 2.5 bathrooms | 3 living areas double garage | terrace