

# HOME design



## Features you'll love

**Zoned living:** Although suited to a smaller block, the design of the home ensures a balance between shared and private spaces. Placing the bedrooms down a hallway amplifies the quiet, private feel and ensures separation from household noise.

**Light filled:** The raked ceiling in the family area allows natural light to flood the space and makes it feel even more spacious than it already is.

**Effortless style:** The grey colour palette is a fantastic base for decorating the interior of the home, providing depth while also ensuring the decor will keep up with trends for years to come.



# A modern masterpiece

Oakford Homes' Oasis design is courting families looking for room to move on smaller allotments but still want unique home design and luxurious features

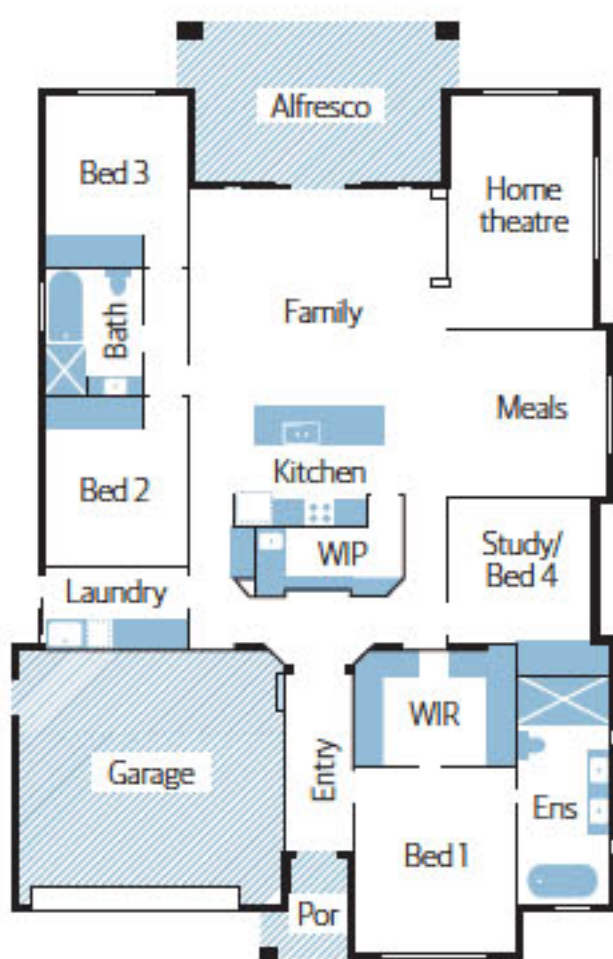

## Homeview

### Off the plan

**Builder** Oakford Homes  
**Design** Oasis  
**Price** From \$317,375 as displayed  
**Location** On display at Fergusson Ave, Blackwood Park estate, Craighburn Farm  
**Open** Sat, Sun, Wed 1pm-4pm  
**Contact** oakfordhomes.com.au, Kimberley Potter 0410 341 694  
**Details** 269.81sqm total size | 206.66sqm living area | 13.97m width | 18.95sqm depth | 2.7m/2.9m/3.2m ceiling height | 4 bedrooms | 2 living rooms | 2 bathrooms | double garage

**W**hen you think of luxurious, grand homes you often think large scale, but Oakford Homes is looking to change that with the Oasis design.

Built to suit a courtyard allotment, the four-bedroom, two-bathroom home cleverly incorporates features often found in two-storey builds – effortlessly blending unique design with practical, family centred features.

On display at Blackwood Park estate in Craighburn Farm, the home features 206.66sqm living space and sits 13.97m wide and 18.95m deep, offering a space-efficient design that packs in a variety of luxurious features.

The facade has a classic street appeal, blending contemporary materials with a classic design. A cream render beautifully contrasts trendy terrazzo-look tiles, with a divine grey fleck that makes a bold statement from the street view and sets a precedent for the rest of the home.

The front entry opens to a hallway, with sandy true wood laminate floors and a crisp colour palette. The master suite is tucked to one side and is nothing short of luxurious, with a moody decor and outstanding features, such as the “his and hers” walk-in robe and the ensuite with a freestanding

bath, a double shower with a wall niche and a double vanity.

While this might already have your boxes ticked, the main feature of the home is beyond doubt the open plan kitchen and family area.

Walking into the space, it's hard to pull your eyes away from the raked ceiling and statement windows, giving the room a spacious and relaxed energy.

Flooded with natural light, this area has been designed with entertaining in mind, with a modern galley-style kitchen featuring stone benchtops and a spacious walk-in pantry, complete with a sink. It overlooks a handy breakfast bar, which blends the kitchen and family area together seamlessly.

A meals area is nestled to the side of the kitchen, perfect for entertaining on those cold winter nights and a private home theatre can be found alongside. Sliding doors open the family room out to an alfresco area, featuring the same statement raked ceiling along with beautiful dark-toned brickwork and tiles.

Heading down a secluded hallway, two bedrooms can be found both with built-in robes and proximity to the main bathroom. It features a deep bath, a shower, a vanity and a toilet, with a warm chocolate colour palette contrasting with the crisp decor.

A fourth bedroom can be found nestled behind the meals area, ideal as an optional study or rumpus room should it be required. Head across the landing to the laundry, tucked away from the living area and featuring ample bench space, storage and a sink, plus outdoor access.

Priced from \$317,375 as displayed, the Oasis is ideal for families looking for that contemporary edge – wanting the style and opulence often found in large-scale builds, but still wanting to meet the requirements of a smaller block.

It's clear Oakford Homes have taken their time designing the Oasis, a build that not only packs in the features you dream of having in your home, but effortlessly mixes them with statement features and a classic style that will remain on trend for years to come.

“  
**Ideal for families looking for that contemporary edge**”